

Schedule 1

Item 1 Description of Agreement Area

A. External boundary description

The area subject to this agreement covers all land and waters subject to:

Lot 4531 on PH1298 that falls wholly within Native Title Determination Application QUD6131/1998 Darumbal People (QC2012/008) as accepted for registration on 23 November 2012.

B. Map

PH1298 V1 Page 1 of 2 Not To Scale

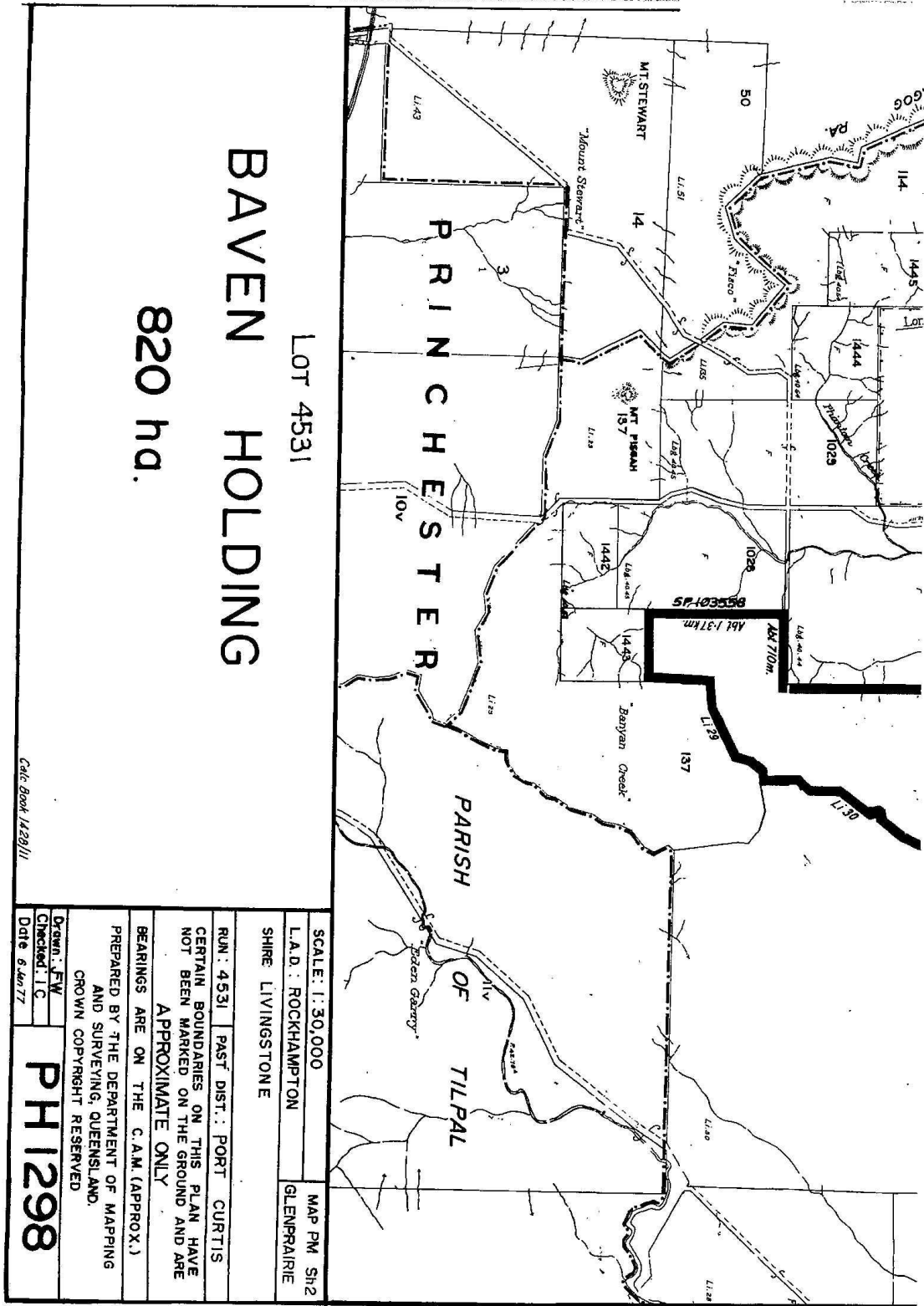

Cada Book 1429/11

SCALE: 1:30,000		MAP PM Sh2
L.A.D.: ROCKHAMPTON		GLENFRAIRIE
SHIRE LIVINGSTONE		
RUN: 4531	PAST DIST.: PORT CURTIS	
CERTAIN BOUNDARIES ON THIS PLAN HAVE NOT BEEN MARKED ON THE GROUND AND ARE APPROXIMATE ONLY		
BEARINGS ARE ON THE C.A.M. (APPROX.)		
PREPARED BY THE DEPARTMENT OF MAPPING AND SURVEYING, QUEENSLAND. CROWN COPYRIGHT RESERVED		
Drawn: FW	PH1298	
Checked: IC		
Date: 6/10/77		

Copyright protects the plan/s being ordered by you. Unauthorised reproduction or amendments are not permitted.

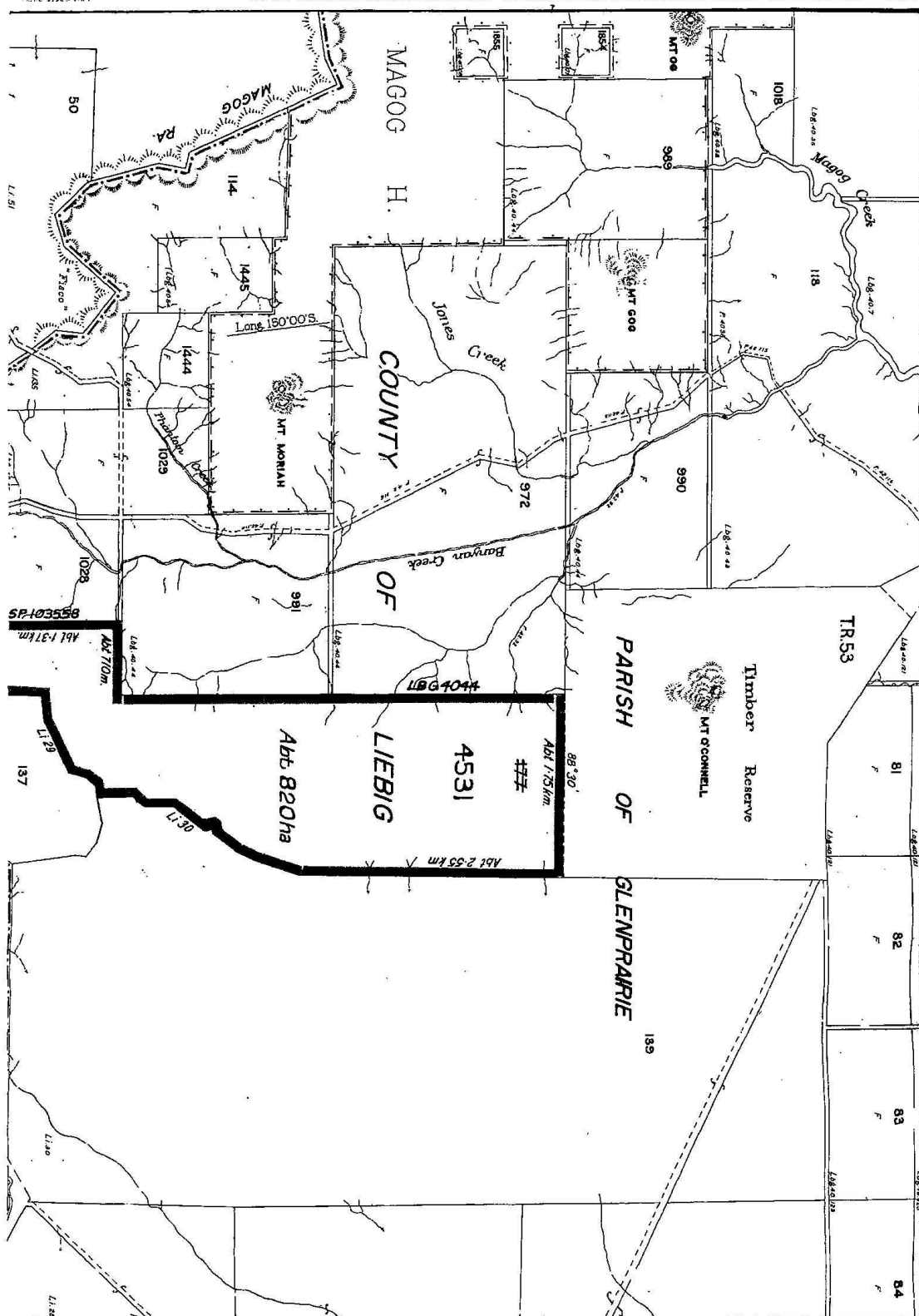

- Item 2 **Description of Lease**
 Pastoral Holding 35/4531 comprising Lot 4531 on PH1298

- Item 3 **Description of Lessee**

Elwyn McDowell Rea, Joanne Belle Rea and Andrew Clyde McDowell Rea